

PETE's Travels

**FREE  
AIRFARE**  
+ \$200 SAVINGS  
PER PERSON  
BOOK BY  
12/31/25



# Danube Explorer

Hungary • Slovakia • Austria • Germany • the Czech Republic

Depart U.S.:	May 05, 2026
Tour Starts:	May 06, 2026
Return Date:	May 15, 2026

**Mayflower**  
CRUISES & TOURS  
A DIVISION OF THE SCENIC GROUP



# Danube Explorer



Vienna's Imperial Hofburg Palace



Visit the village of Weiskirchen located in the Wachau Wine Region

**DAY 1 Depart the USA:** Depart the USA on your overnight flight to Budapest, Hungary.

**DAY 2 Budapest, Hungary:** Welcome to the 'Pearl of the Danube'. You will be met at the airport and transferred to your Emerald Cruises Star-Ship, home for the next seven nights. Flights should arrive Budapest prior to 5:00pm. This evening, join your fellow guests for a folklore performance onboard and a traditional Hungarian dinner. After dinner, relax on the Sun Deck and enjoy the fabulous view of the city, aglow in nighttime splendor. **Meal: D**

**EmeraldPLUS:** A traditional Hungarian folklore show onboard

**DAY 3 Budapest:** Explore Budapest's cobbled medieval quarter, as you embark on a coach tour through the UNESCO World Heritage city center. Your guide will highlight a number of architectural wonders and also talk about Budapest's culinary scene. The tour will end at the Grand Market Hall, the city's most expansive indoor food & craft market, where you'll have time to explore on your own. If you are feeling more active, you may instead choose to hike to Gellert Hill. The surrounding area has been rebuilt several times, most recently following the air raids of WWII. Some 18th-century Baroque houses still stand, best explored by foot along the medieval paths and alleyways in the area around Buda Castle. **Meals: B, L, D**  
**EmeraldACTIVE:** Guided hike to Gellert Hill (instead of city tour)  
**DiscoverMORE:** Szentendre (additional expense)

**DAY 4 Bratislava, Slovakia:** This morning, relax onboard while sailing into the capital of Slovakia. This graceful nation became an independent country in 1993, and since then, Bratislava has flourished as a new capital and made a name for itself as a cultural center. The romantic cobblestone lanes that weave through the city are explored with your local guide, as you enjoy a walking tour of the ancient town center, seeing the Slovak National Theater and a range of Gothic and Art Nouveau buildings. For the more active guests, embark on a guided hike to Bratislava Castle, a landmark steeped in legends that looks as though it came from the pages of a fairytale book. **Meals: B, L, D**

**EmeraldACTIVE:** A guided hike to Bratislava Castle (instead of city tour)

**EmeraldPLUS:** Local Slovakian entertainment onboard

**DiscoverMORE:** Carpathian Wine Route (additional expense)

**DiscoverMORE:** Skoda tour of post-Communist Bratislava (additional expense)

**DAY 5 Vienna, Austria:** Welcome to Vienna, Austria's capital and the capital of classical music. The city perfectly encapsulates the opulence of the Habsburg Monarchy and their ornate Baroque palaces. On the included city tour, see monuments and buildings of grandeur as the coach drives along the famous Ringstrasse. During the walking tour, stroll with your guide through the city center, a UNESCO World Heritage Site. Marvel at the classical architectural styles of the buildings, see St. Stephen's Cathedral and the Hofburg Palace, right in the heart of the city center. If you are feeling more active, opt to explore on two wheels, cycling along the river to Danube Island. **Meals: B, L, D**

**EmeraldACTIVE:** Bike tour in Vienna (instead of city tour)

**DiscoverMORE:** An exclusive Viennese evening concert with the music of Mozart and Strauss (additional expense)

**DAY 6 Weissenkirchen – Melk:** Effortlessly suspended in time, Weissenkirchen is one of the most frequented parts of the Wachau wine region, where the delightful warm weather creates the perfect setting for viticulture. Join your Activity Manager for a hike in town before sailing to Melk. Later this morning, sail through the UNESCO World Heritage Wachau Valley, passing medieval villages, terraced vineyards and areas of natural beauty. Upon arrival in Melk, enjoy a guided tour of Melk Abbey, a UNESCO World Heritage Site, originally a lavish castle that was gifted to Benedictine monks during the 11th century. This opulent Baroque building is home to some of the most important collections of medieval manuscripts in the world. **Meals: B, L, D**

**EmeraldACTIVE:** Hike in Weissenkirchen (instead of bike ride along the Danube)

**EmeraldACTIVE:** A guided bike ride along the Danube (instead of hike in Weissenkirchen)

**DiscoverMORE (from Melk):** Visit to Schallaburg Castle (additional expense)

**DAY 7 Linz, Austria / Český Krumlov, Czech Republic:** Today's adventure takes you to the UNESCO World Heritage town of Český Krumlov. With its 13th-century castle, meandering river, and a maze of quaint alleyways, this town has one of the best-preserved centers in Europe. Join your local guide to traverse a labyrinth of winding cobblestone lanes as you experience the charming atmosphere of Český Krumlov's medieval buildings, the iconic castle complex and the 15th-century St. Vítus' Church, a highlight





Old Town Square, Prague, Czech Republic

of the town. Alternatively, choose the DiscoverMORE option to visit Salzburg, Austria. **Meals: B, D**

**EmeraldPLUS\***: A guided tour of Ceský Krumlov

**DiscoverMORE\***: Linz Walking Tour with a Linzer torte tasting (additional expense)

**DiscoverMORE\***: Full day to Salzburg (additional expense)

\*Included tour and both DiscoverMORE's operate simultaneously; only 1 can be selected

**DAY 8 Passau, Germany**: Narrow cobblestone streets welcome you to Passau, a town nestled on the confluence of three of Europe's main waterways. On today's excursion, venture out to a local farm to gain a fascinating insight into the life of local Bavarian farmers. Meet with the farmers and sample some of their homemade specialties.

**Meals: B, L, D**

**EmeraldPLUS**: Bavarian Countryside Experience

**EmeraldACTIVE**: Guided hike to Veste Oberhaus (instead of farm visit)

**DiscoverMORE**: Bavaria Live (additional expense)

**DAY 9 Passau – Prague, Czech Republic**: After breakfast, say goodbye to your Captain and crew as you disembark your ship and depart by motorcoach for Prague, Czech Republic. After checking into your hotel, the remainder of the day is left free of planned activities for your independent exploration of Prague. **Meal: B**

**DAY 10 Prague**: This morning, discover the heart of the city on foot as you embark on an included walking tour. Explore all of the famous sites, such as the Old Town Square with its historic astronomical clock, and the medieval Charles Bridge. This afternoon, you may choose to join the optional excursion to Terezin Concentration Camp, or, continue exploring this beautiful city on your own. **Meal: B**

**DiscoverMORE**: Terezin Concentration Camp (additional expense)

**DAY 11 Prague / USA**: Bid a fond farewell to Europe and return home with wonderful memories of life enriching experiences from your cruise along the Danube River. **Meal: B**

Itinerary and excursions are subject to change.



## Exceptional Inclusions

- **21 Meals**: 9 breakfasts, 5 lunches, and 7 dinners
- **Airport transfers** on tour dates when air is provided by Mayflower Cruises & Tours
- Visit **five countries**
- **Seven-night cruise in a suite or stateroom** of your choice onboard the vessel
- **All gratuities included**
- **First-class service** by an English-speaking crew
- **Onboard Activity Manager** will support all EmeraldACTIVE excursions and host daily onboard wellness activities, games, classes and evening entertainment
- **Shore excursions** with English-speaking local guides
- Personal **listening device** for onboard excursions
- Most meals included onboard with a **variety of international cuisine**
- Complimentary **regional wines, beer and soft drinks** accompany onboard lunches and dinners
- Complimentary **bottled water** in your stateroom
- Complimentary **WiFi onboard**
- Complimentary **bicycles onboard** for use ashore
- **All port charges included**
- Two-night **hotel stay and touring** in Prague, the Czech Republic

## CRUISE AND HOTEL ACCOMMODATIONS

**Days 2 through 8** – Aboard an Emerald Cruises Star-Ship

**Days 9 and 10** – Hotel Jalta or similar, Prague, Czech Republic

Pre-cruise hotel stays available in Budapest. Call for details.

# Emerald Cruises Star-Ships

**Built:** 2014-2026 **Speed:** 15.5 mph **Staterooms:** 19 **Suites:** 72 **Length:** 443 ft. **Crew:** 47

## SUN DECK

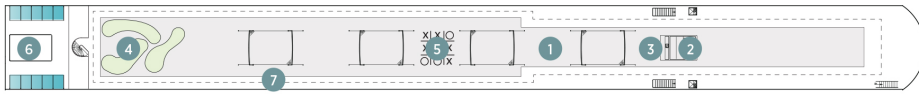

## HORIZON DECK

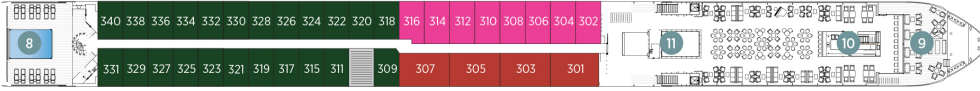

## VISTA DECK

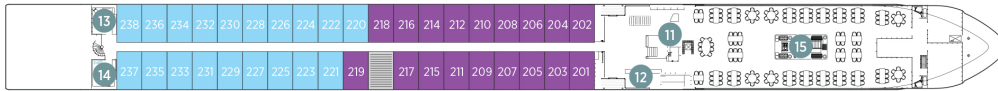

## RIVIERA DECK

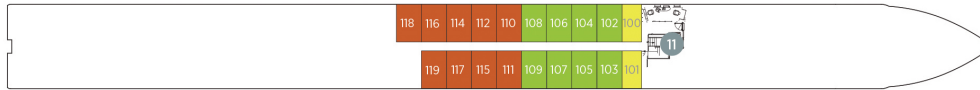

## Public Areas and Ship Amenities

- 1 Sun Deck with Deck Chairs
- 2 Navigation Bridge
- 3 Sky Barbeque
- 4 Golf Putting Green
- 5 Games Area
- 6 Retractable Glass Roof
- 7 Walking Track
- 8 Daytime Pool / Evening Cinema
- 9 The Terrace
- 10 Horizon Bar and Lounge
- 11 Elevator
- 12 Reception
- 13 Wellness Area
- 14 Fitness Area
- 15 Reflections Restaurant

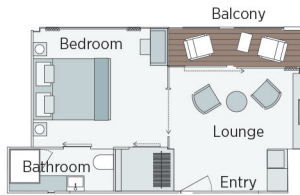

**Owner's One-Bedroom Suite**

315ft<sup>2</sup>

**CAT SA**

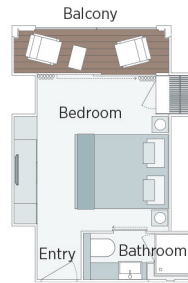

**Grand Balcony Suite**

210ft<sup>2</sup>

**CAT S**



**Panorama Balcony Suite**

180ft<sup>2</sup>

**CAT A CAT B CAT C**

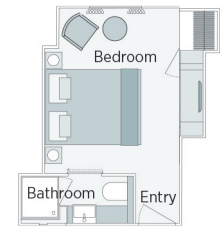

**Emerald Stateroom**

162ft<sup>2</sup>

**CAT D CAT E**

## Danube Explorer River Cruise

Danube Explorer River Cruise			MAY 5, 2026	
			PER PERSON TWIN	SINGLE ROOM ADD
CAT	STATEROOM / SUITE	DECK		
E	Emerald Stateroom	Riviera	\$5,605	+ \$3,925
D	Emerald Stateroom	Riviera	\$5,659	+ \$3,965
C	Panorama Balcony Suite	Vista	\$6,565	+ \$4,599
B	Panorama Balcony Suite	Vista	\$6,625	+ \$4,639
A	Panorama Balcony Suite	Horizon	\$6,985	+ \$4,895
S	Grand Balcony Suite	Horizon	\$7,715	N/A
SA	Owner's One-Bedroom Suite	Horizon	\$8,309	N/A

**FREE AIRFARE** when booked within promotional window.

Please call for details.



## Travelers Protection Plan (TPP) for River Cruises - \$569 per person (non-refundable)

This nonrefundable fee will provide a refund to you during the instance that you have to cancel your trip. The cancellation has to be for a covered reason (see Plan for details on coverage) and we have to be notified at least one day prior to departure. If you must leave the tour early due to personal illness or the illness or death of an immediate family member, TPP will provide a refund for any unused services after the departure of the tour. Other benefits include medical expenses for illness and injury, emergency transportation, 24 hour hot line and lost or stolen baggage assistance. Return air transportation is included ONLY if your air tickets are purchased through Mayflower Cruises & Tours. Please review the Plan for details on coverage. Should you choose not to purchase our TPP, the following per person cancellation charges will be assessed for all tours and optional excursion costs:

- 91 days or more prior to departure: Deposit Amount
- 90 days to day of departure: 100% of total tour
- No refund on unused portions of the tour

**Exclusions:** Mayflower Cruises & Tours reserves the right to alter its Refund and Cancellation Policy when a substantial amount of cancellation or postponement of travel is attributable to: conditions resulting from an act of God, natural or man-made disaster, fire, government action, civil disorder, war, hostilities between nations, or unavailability of transportation through no fault of Mayflower Cruises & Tours. *Plan and benefits offered and administered by Trip Mate, Inc.*

FOR RESERVATIONS OR INFORMATION CONTACT:

**Petes Travel Trips**  
**PetesTravelTrips.com**  
**Petestraveltrips@gmail.com**  
**Phyllis Earnest**